

Spider  Farmer

USER MANUAL

SEED STARTING TRAYS

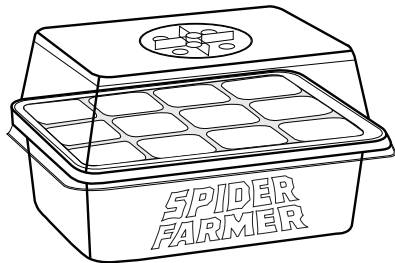



Seed Starter Tray with Humidity Dome 12 Cells Per Tray

For Base Mini Greenhouse Seeds Growing Start Plant Germination

HOW TO USE

Method of soil



Put the soil in the hole of the seedling tray with the garden tool.

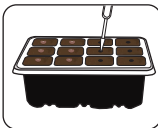

Use the tool to make hole and add one or two seeds.



Watering the seeds.

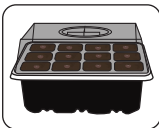

Close the dome cover and adjust the air vents.

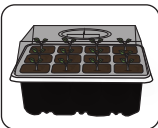

After seeds germinate, it can be transplanted as required.

Method of hydroponics

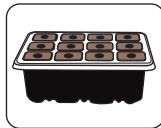

Put in the grow sponges plugs.



Adding one or two seeds in each hole.

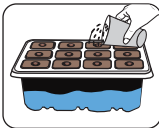

Watering the seeds, soak the bottom one third of the cells tray.

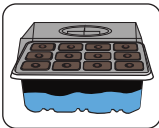

Close the dome cover and adjust the air vents.

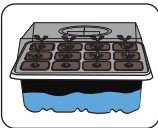

After seeds germinate, it can be transplanted as required.

Specifications:

Seed Starter Tray(Total): 7.5**5.9**4.1"

Per Cell Size: 1.5**1.5**2.2"

Humidity Dome Cover: 7.6**5.9**2.4"

Package Includes:

- 4 x Seedling Trays
- 4 x Waterproof Base Trays
- 4 x Clear Humidity Domes
- 4 x Air Vents
- 4 x White Labels
- 2 x Garden Tools
- 1 x User Manual

